

Installation Instructions for SPI Range Extender - ACL-SPI-EXT-Rx

Thank you for your purchase of our Range Extender-Receiver ACL-SPI-EXT-Rx. Prior to installing the product, we kindly request that you carefully review all the provided instructions. For any specific programming requirements tailored to your needs, please reach out to our LED department at led@allanson.com

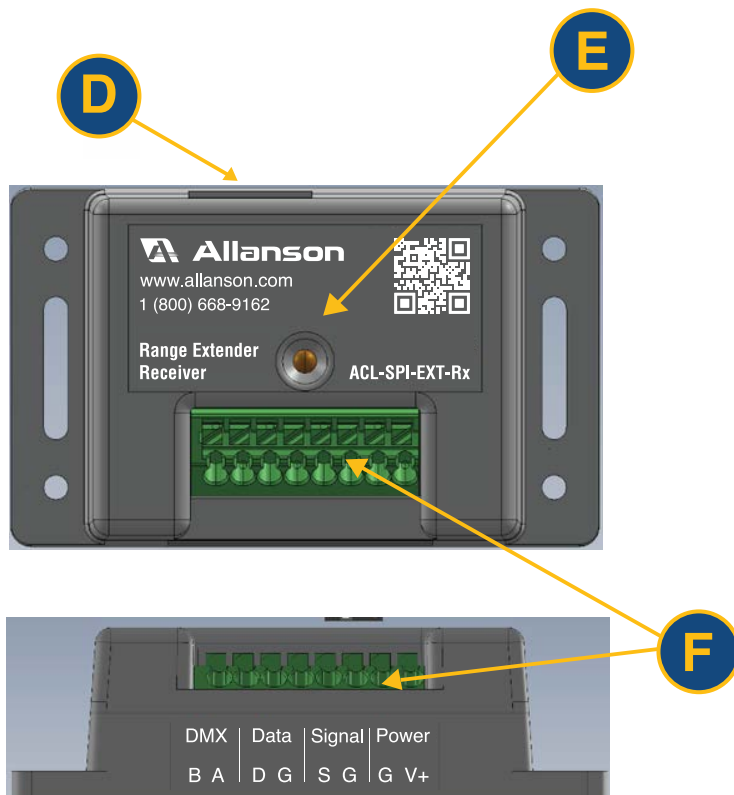

Range Extender-Receiver ACL-SPI-EXT-Rx

Operating Voltage: DC 12V / 24V

Maximum Power: 5W

Signal In: Encoded TTL-SPI signal to RJ45

Signal Output: TTL-SPI from Terminal Block (S, G)

Dimensions (LxWxH): 3.0" x 1.8" x 0.88"

The **ACL-SPI-EXT-Rx** requires an Allanson 12V DC or 24V DC class 2 power supply. Its primary function is to act as a Range Extender-Receiver. This unit is compatible with the following products and need to purchase Range Extender – Transmitter based on your application

- Range Extender-Transmitter **ACL-SPI-EXT-Tx**
- 4x SPI Range Extender – Transmitter **ACL-SPI-Tx/0-SPL/4**
- 4x SPI Splitter & Range Extender- Transmitter **ACL-SPI-Tx/4-SPL/0**

- D. **RJ45**
Encoded TTL-SPI signal Input from the Transmitter
- E. **Power Indicator**
Lights on when DC power
- F. **Terminal Block**
DMX Signals.....A, B (not used)
Data Out.....D, G (not used)
TTL-SPI Signal Out.....S, G
Power.....V+, G



Note

- Allanson Power supply CV12 or CV24 series should be used to match the 12VDC or 24VDC LED module/fixture rated operating voltage.
- It's recommended to use wire gauge AWG 24-18, solid or stranded, with strip length of 6mm for the terminal block connections.

Attention

- The product shall be installed and serviced by a qualified person.
- This unit is a water splash proof product. Please avoid the direct sun and rain and that will prolong the working life of the controller. Please ensure good ventilation.
- Please check if the output voltage of the LED power supply used complies with the working voltage of the product.
- Please ensure that proper wire gauge is used from the controller to the LED power supply and RGBW products to carry the current.
- Ensure all wire connections and polarities are correct before applying power to avoid any damage to the LED and RGB products.
- If a fault occurs, please return the product to your supplier. Do not attempt to fix this product by yourself.
- This manual only applies to this model. Allanson reserves the right to make changes without prior notice.

Applications - with ACL-SPI-EXT-Tx

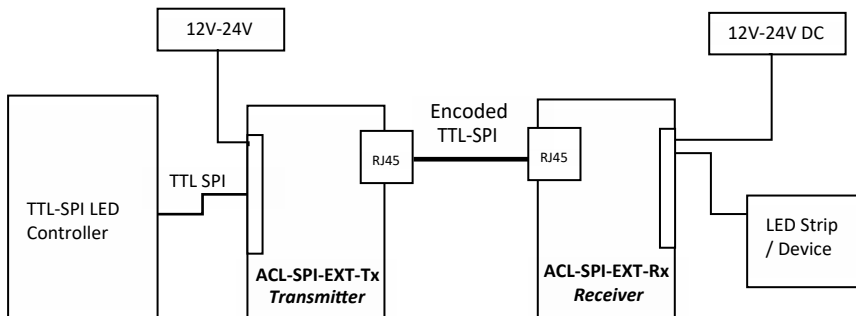

Wire Connection

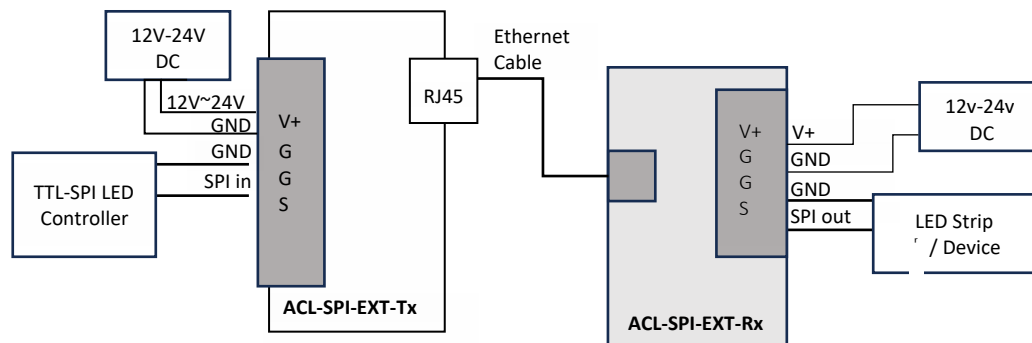

Applications - with ACL-SPI-Tx/0-SPL-4

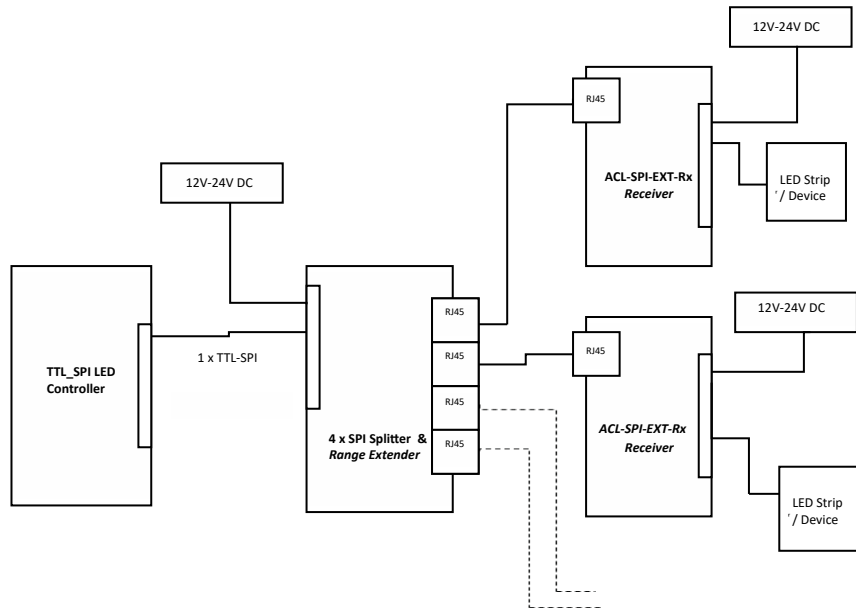

Applications - with ACL-SPI-Tx/4-SPL-0

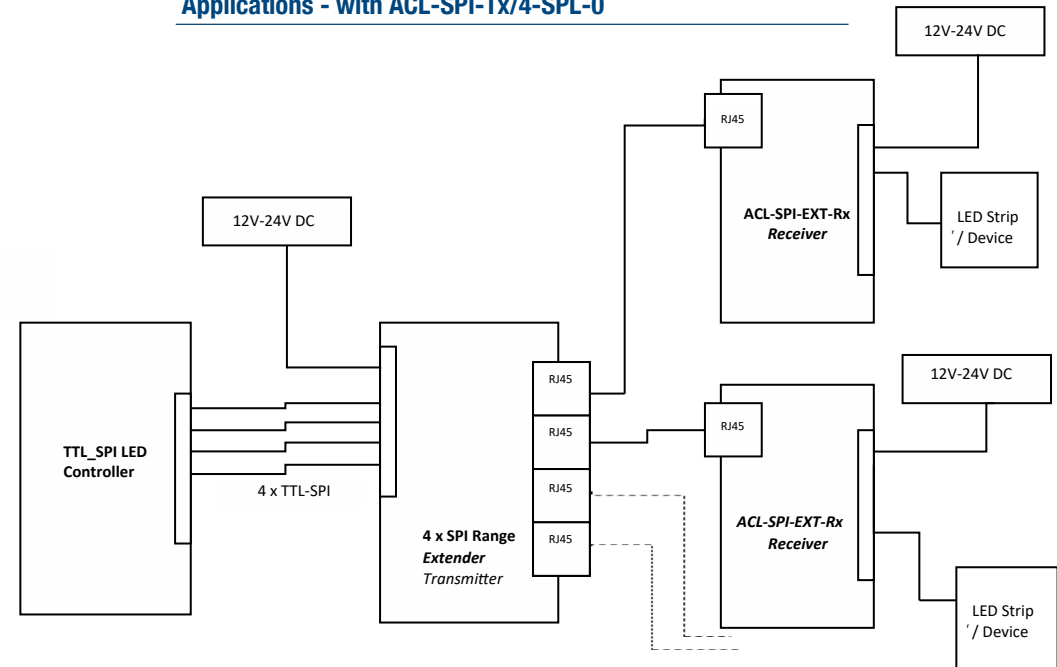

Wiring Connection

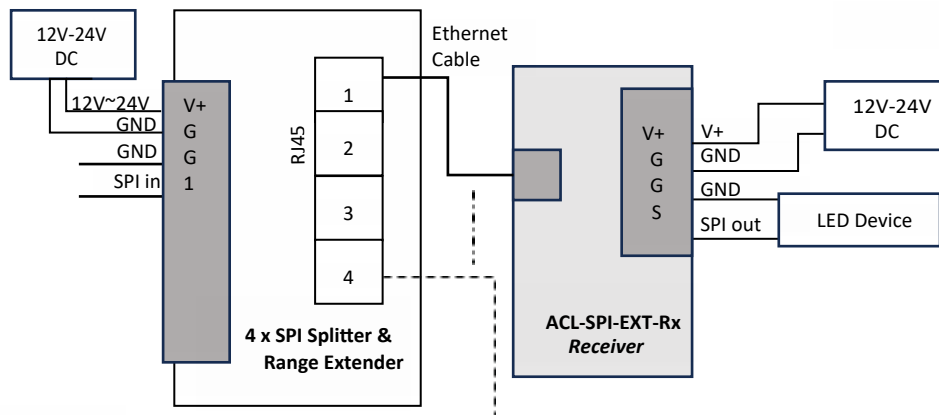

Wiring Connection

